

SALES MAP GARDEN OF VALOR KNOLLWOOD MEMORIAL PARK CANTON, MASSACHUSETTS

NOTES

- 1) GRAVE SIZE IS 3'-0" X 8'-0".
- 2) TYPICAL PATH SIZE IS 2'-0" OR AS NOTED.
- 3) PAVEMENT EDGE TO LOT RESERVATION IS 3'-0" MINIMUM.
- 4) AREA OF DESIGN IS 1.74 ACRES ±.
- 5) UNDERGROUND UTILITY LOCATIONS ARE NOT GUARANTEED, NOR IS THERE ANY GUARANTEE THAT ALL EXISTING UTILITIES (WHETHER FUNCTIONAL OR ABANDONED) WITHIN THE PLANNING AREA ARE SHOWN ON THIS DRAWING.

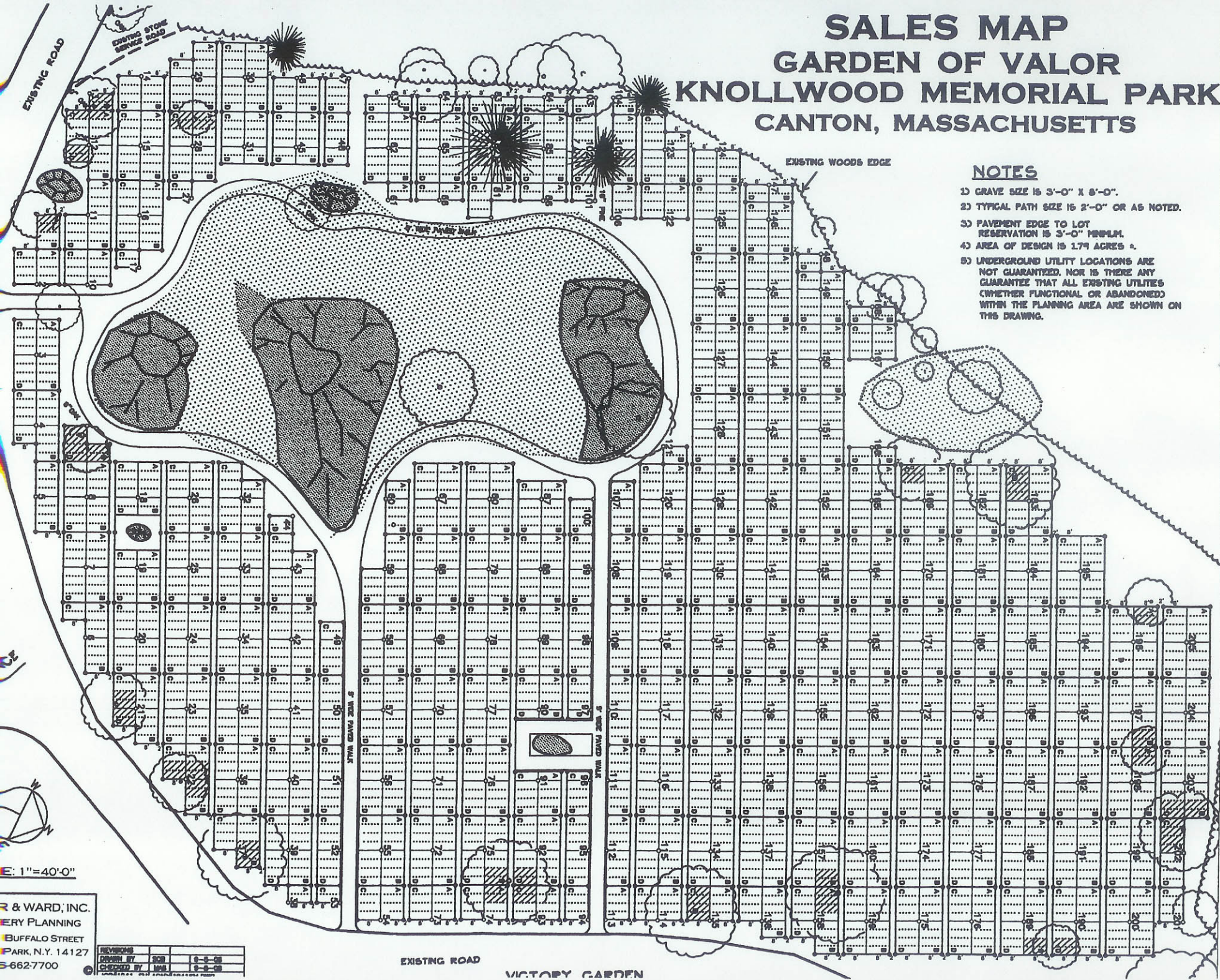

E: 1"=40'-0"

R & WARD, INC.
 ERY PLANNING
 BUFFALO STREET
 PARK, N.Y. 14127
 662-7700

REVISIONS	DATE	BY	CHKD BY

EXISTING ROAD VICTORY GARDEN